

- One pair of the M16 superhinges is suitable for gates up to 150kg and the M30 version can take gates up to 900kg
- Tested to 500'000 openings with no wear - this is equivalent of 50 years at an average of 25 openings a day
- Low friction, which makes it ideal for use with automatic gates



PRODUCT DETAILS

Product code:                      Description:

- 0515S161**
- Superhinge M16 x 100mm - Tested Low Friction**  
**Suitable for up to 150kg per pair**
- 0515S181**
- Superhinge M20 x 125mm - Tested Low Friction**  
**Suitable for up to 300kg per pair**
- 0515S251**
- Superhinge M24 x 150mm - Tested Low Friction**  
**Suitable for up to 400kg per pair**
- 0515S301**
- Superhinge M30 x 200mm - Tested Low Friction**  
**Suitable for up to 900kg per pair**

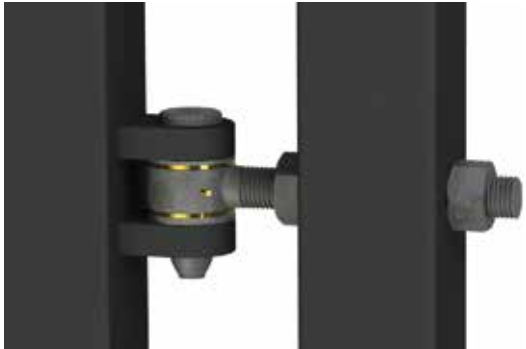

Code	Thread mm	Dimensions (mm)					
		A	B	C	D	E	F
0515S161	M16 x 100	36	36	54	15	58	100
0515S181	M20 x 125	40	40	62	16	66	125
0515S251	M24 x 150	57	40	69	20	80	150
0515S301	M30 x 200	64	45	77	24	94	200

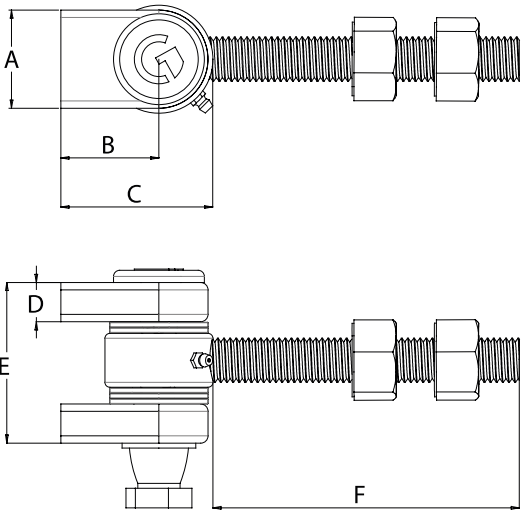

Brass bearings  
Low friction, ideal for use with automated gates  
One pair of hinges will support gates from 300kg (150kg per hinge)  
to 900kg (450kg per hinge)

INSTALLATION

1. Disassemble the 2 self colour lugs from the hinge and weld in position to the gate post.
2. Drill a hole through the gate frame to suit the thread size.
3. Once the gate has been galvanised or painted, assemble the hinge and use the 2 nuts to adjust the position of the gate.
4. **MAINTENANCE:** Lubricate during fitting and once every 6 months to ensure maximum product life.

Whilst every effort has been made to ensure the accuracy of the information supplied. F.H. Brundle cannot be held responsible for any errors or omissions. This product must only be employed for its original intended use. Any other use is wrong and potentially dangerous. Installation must be carried out in full compliance with current regulations. F.H. Brundle cannot be held liable for any damages resulting from wrongful, erroneous or negligent use.